

U. S. Department of Labor

Mine Safety and Health Administration
100 Bluestone Road
Mount Hope, WV 25880-1000



SEP 18 2009

Mr. Chris Blanchard
President
Performance Coal Company
POB 69
Naoma, WV 25140

Dear Mr. Blanchard:

Subject: Mine Ventilation Plan, Section 75.370, 30 CFR 75, Upper
Big Branch Mine-South, I.D. No. 46-08436, Performance
Coal Company, Montcoal, Raleigh County, West Virginia

This will acknowledge receipt of the ventilation revision dated September 10, 2009, and received by MSHA on September 14, 2009. The ventilation revision is to construct two (2) regulators between breaks 33 and 34 of Tailgate 1 North in entries 4 and 5 to limit the amount of neutral air going to the longwall tail.

The revision is hereby approved and will become a part of the approved plan for this mine. The approval is limited to the requested changes as described in the submittal letter and shown on the map.

Should you have any questions concerning this matter, please contact the Ventilation Department at (304) 877-3900/Ext. 142.

Sincerely,

/s/ ROBERT G. HARDMAN

Robert G. Hardman
District Manager
Coal Mine Safety and Health, District 4

Cc: Mt. Hope Field Office (3incl.)/ Files/nlc

SUPERVISORY ACKNOWLEDGEMENT

RE 9/17/09
Initials *RMH* Date 9/17/09



SEP 18 2009

Mr. Chris Blanchard
President
Performance Coal Company
POB 69
Naoma, WV 25140

Dear Mr. Blanchard:

Subject: Mine Ventilation Plan, Section 75.370, 30 CFR 75, Upper
Big Branch Mine-South, I.D. No. 46-08436, Performance
Coal Company, Montcoal, Raleigh County, West Virginia

This will acknowledge receipt of the ventilation revision dated September 10, 2009, and received by MSHA on September 14, 2009. The ventilation revision is to construct two (2) regulators between breaks 33 and 34 of Tailgate 1 North in entries 4 and 5 to limit the amount of neutral air going to the longwall tail.

The revision is hereby approved and will become a part of the approved plan for this mine. The approval is limited to the requested changes as described in the submittal letter and shown on the map.

Should you have any questions concerning this matter, please contact the Ventilation Department at (304) 877-3900/Ext. 142.

Sincerely,

A handwritten signature in black ink that reads "Robert G. Hardman". The signature is written in a cursive, flowing style.

Robert G. Hardman
District Manager
Coal Mine Safety and Health, District 4



Performance Coal Company

P.O. Box 69

Naoma, WV

25140

September 10, 2009

Mr. Robert Hardman
Mine Safety and Health Administration
100 Bluestone Road
Mount Hope, WV 25880

Re: Performance Coal Company
Upper Big Branch Mine
MSHA ID : 46-08436
State ID: U-3042-92
Ventilation Revision

Dear Sir:

Please find the enclosed ventilation revision for the Upper Big Branch Mine for your review and approval. This revision is to install two regulators between breaks 33 and 34 of Tailgate 1 North. These regulators will be installed in entries 4 and 5 to limit the amount of neutral air going to the longwall tail.

At the current time the Upper Big Branch Mine does not have a miner's representative. If you have any questions or concerns feel free to contact me at (304) 854-3516.

Respectfully Submitted,
Performance Coal Company, Inc.

Eric Lilly
Mine Engineer

MSHA
MOUNT HOPE, WV

SEP 14 2009

RECEIVED
VENTILATION

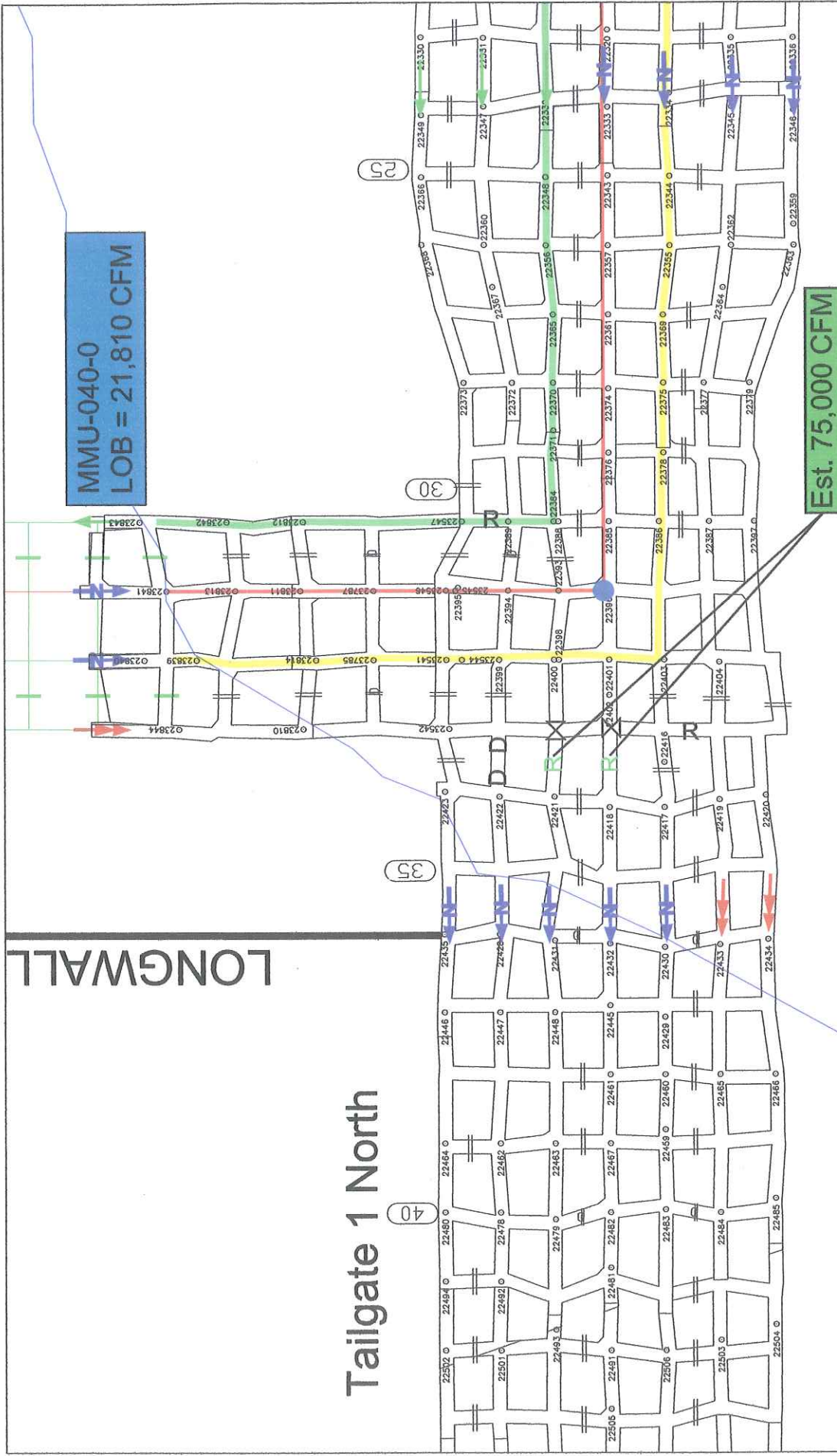

MMU-040-0
LOB = 21,810 CFM

Est. 75,000 CFM

Tailgate 1 North

LONGWALL

PERFORMANCE COAL COMPANY
P.O. BOX 89, NAOMA, WV 25140

UPPER BIG BRANCH MINE
M.S.H.A. ID No. 05-08436 WV ID No. U-3042-92

Date: 08-10-09 SCALE: 1"=200' DWG No. 1 of 1
DRAWN BY: R-3 Slsf CHECKED BY:

PREPARED BY

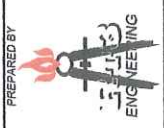

A/E/C ENGINEERING

VENTILATION REVISION

TAILGATE REGULATORS

INTAKE AIR	BOX CHECK	FAN	ROADS
SECONDARY INTAKE AIR	ACTIVE OR INACTIVE GAS WELL	SEALS	GAS LINES
RETURN AIR	PLUGGED GAS WELL	PROPOSED BELT HEAD	CORE HOLE
PRIMARY ESCAPEWAY	PROPOSED GAS WELL	BELT HEAD	ESCAPEWAY (PROPOSED/PRIMARY)
ALTERNATE ESCAPEWAY	PERMANENT STOPPINGS	OVERCAST	ESCAPEWAY (ALTERNATE)
PROPOSED BELT	PROPOSED STOPPINGS	AIRLOCK DOOR	
EXISTING BELT	AUGER WORKS	REGULATOR	
PROPERTY LINES	AUGER AREA	ADJACENT MINING	
200' TEST DRILL LINE	CHECK CURTAIN	COAL CONTOURS	
100' COVER BOUNDARY	PROPOSED SEALS	WATER	
APPROVED MINE LIMITS	RAILROAD	INTERMITTENT STREAM	
TRACK	POWER LINES	PERMANENT CONTROL MONUMENTS	
MAN DOOR			

MSHA
MOUNT HOPE, WV

SEP 14 2009

RECEIVED
VENTILATION